

Beerburrum Forestry District

Brandon's West Bellthorpe Mill

Location

The sawmill and settlement at West Bellthorpe is located about 6 kilometres north west of Bellthorpe township. The site is also directly accessible from Brandon's Road from the Woodford-Kilcoy road.

Sawmill GPS 26°49'28" S, 152°40'44" E.

Recommended Heritage Boundaries

The recommended boundaries are such as to encompass as the existing buildings and structures in the West Bellthorpe township.

History

In the area between Woodford and Glass House Mountains there were several mills around Bellthorpe. Peter N. Levy [presumably a mistake for Lovf] was listed there in 1914. Ken L. Keir and later H.M. Keir were sawmilling from the mid 1930s.

Brandon began around 1940. After Main Roads Commission resumed where Olsens had their Nundah sawmill in Brisbane, Brandon with Walter Lovf bought Olsen's Mill and erected it at Bellthorpe, trading as Brandon Lovf Pty Ltd. It operated until 1963. The mill was then purchased by Grant Timbers for the quota and added to their Woodford Mill.¹

Site Description and Condition

The sawmill shed, log handling gantry, school buildings and several residences and minor structures remain intact creating the atmosphere of the sawmill village, except that the sawmill has closed. Furthermore, all the sawmilling machinery has been removed from within the sawmill. Some of the rails have been removed from the main girders of the gantry and through lack of maintenance the girders on one side are out of alignment and partially dislodged from the headstock. The sawmill shed is in a fairly good state of repair given many years lack of maintenance. The school buildings and residences appear to be in good repair.

Assessment of Significance

The West Bellthorpe sawmill structures and associated residences are typical of a sawmilling community of the mid 20th century (criterion d), a once common form of community which is now rare. The wooden gantry is also rare (criterion b). The sawmill is also strongly associated with T.W. Brandon who established one of the major sawmilling family businesses which continued for three generations (criterion h). Because all the sawmill machinery has been removed, the sawmill shed on its own may not likely to achieve threshold on any criterion.

Recommendations

As this is one of the best preserved sawmill communities, it is recommended that the history of the enterprise and community be fully researched and a detailed assessment be made of the settlement's heritage values *in toto*. If the outcome is positive, steps should then be taken to negotiate and act so that the area may be heritage listed.

References

1. Stan Tutt, *Sunshine Coast Heritage*, p. 87; Red Folder 4, Bellthorpe, M. Kowald, DoE; interview Mr Bill Brandon.

Brandon's West Bellthorpe Mill



General View of Sawmill Shed



General View of Gantry

Brandon's West Bellthorpe Mill

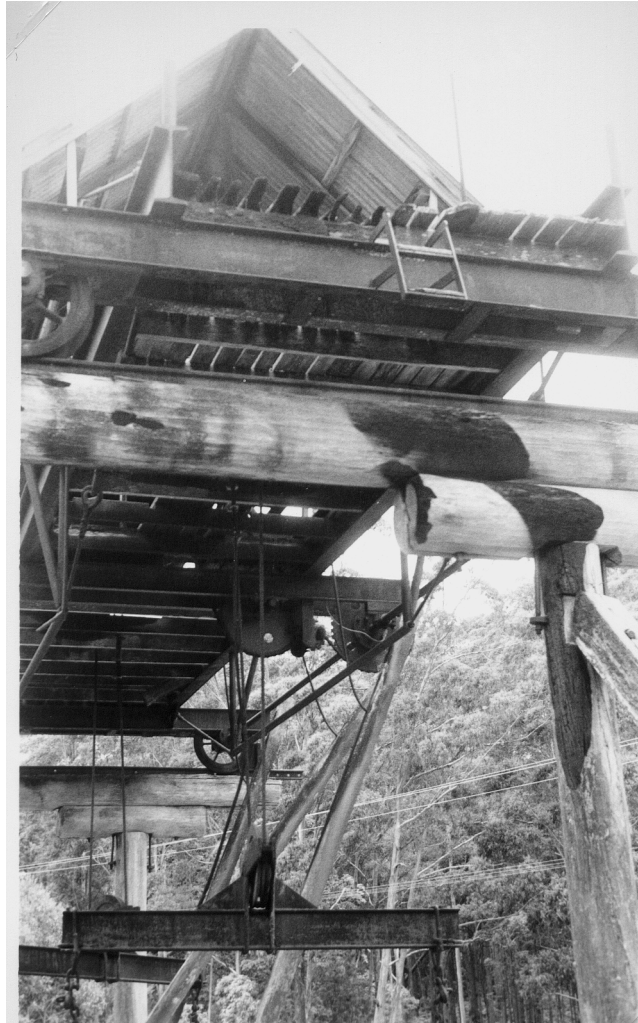

Underneath view of travelling
lifting gear of log gantry

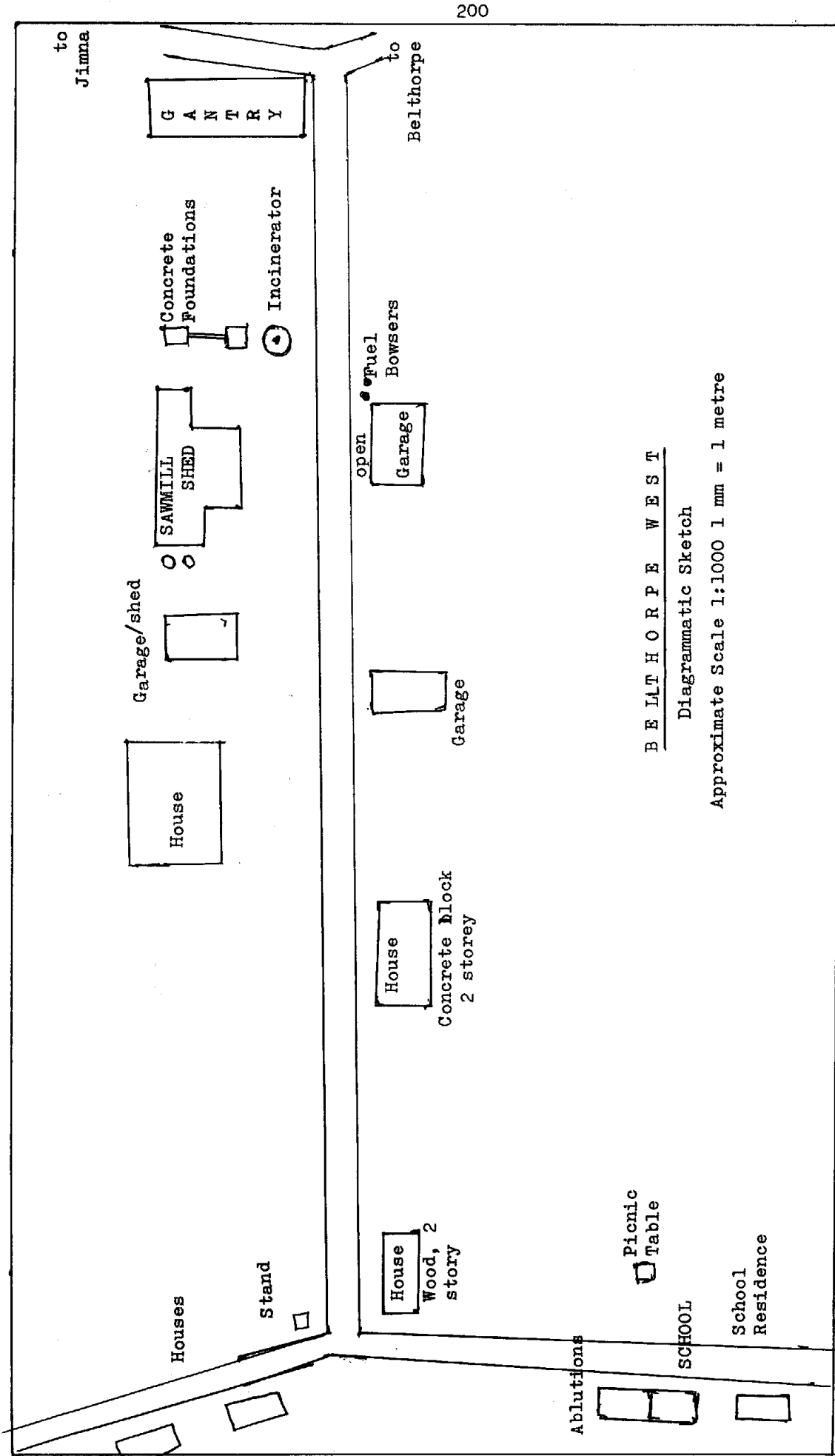

201

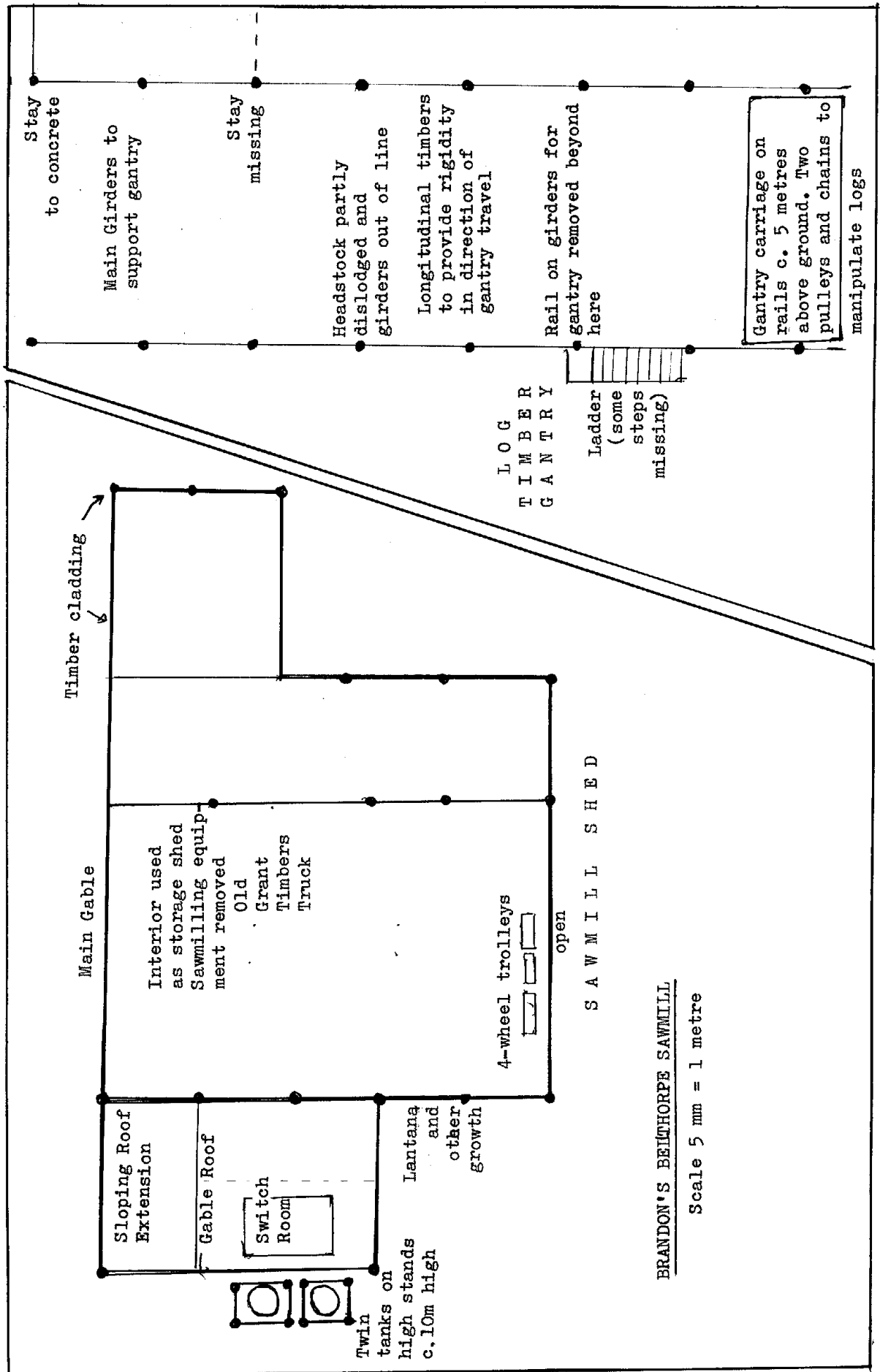

BRANDON'S BELTHORPE SAWMILL

Scale 5 mm = 1 metre

Beerburrum Forestry District

Burnett's Creek Sawmill

Location

Beside the road which formerly led to the Boonah border gate; this is now a barely maintained road marked a 'No Through Road' branching from the road at a point identified by GPS as 28 deg 14 min 36 sec S and 152 deg 35 min 7 sec E. The mill site is three kilometres on this road at a low open site, GPS 28 deg 16 min 29 sec S 152 deg 34 min 15 sec E.

Recommended Heritage Boundaries

The recommended heritage boundaries extend ten metres from the concrete boiler and engine foundations and tramway rails set in mass concrete. The remaining house nearby and the stumps of a former building on higher ground to the north of the mill site and respectively on the eastern and western sides of the road have not been included.

History

James Cossart established a branch mill at Burnett's Creek, Maroon in hoop pine forests in 1899, moving it to White Swamp (NSW) in 1907 and back to Dugandan in 1922.¹ The Burnett Creek Provisional School functioned from 1902 to 1921, at the foot of Mount Ballow, both Cossarts and Hancocks operating sawmills nearby.²

The Hancocks took large quantities of pine off Mount Clunie with a flying fox and constructed miles of road (in the pre-bulldozer period). Hancocks later got a timber concession between Mount Clunie and Mount Ballow and put up a breaking-down mill at The Gorge further up Burnett Creek. A Lynn tractor was used bringing logs to motor lorries in the 1927-29 period from the Gorge at Burnett's Creek and from White Swamp Road. Hancocks built the access road and gravelled it.³ Hancock were operating at Burnett Creek from around 1949. The mill seems later to have been bought by Enright's of Beaudesert and a relic from it is displayed at their Beaudesert mill.

Site Description and Condition

The only remains of the sawmill at this site are the concrete and steel, chiefly the foundations for the boiler and engine, overgrown with lantana and weeds, and the rails set in concrete used as a system of moving logs and timber for sawing up.

There is a small cylindrical tank on the site the purpose of which is not known and may not be related to the sawmill.

Assessment of Significance

These remains are typical of what is left of a bush sawmill and settlement operating until relatively recent times (mid 20th century). All the machinery has been removed, presumably at the time of closure, leaving only the foundations and tramway track. These remains and the nearby fibro house, one of a small number provided for workers, provide the remaining evidence of sawmilling in the area which is now largely devoid of population. Sawmilling was the principal occupation in the area and the remains provide a reminder of the importance of sawmilling to this area in former years. In the absence of other evidence, this may be sufficient to make the area significant (Criterion a). The sawmill remains are those of a mid 20th century sawmill and may be significant under criterion (d).

Recommendations

A sign would inform the visitor of the former importance of this site to the region when it was an active timber producer. The nature of the remains is such that little action is needed to preserve them in their natural state of slow decay.

References

1. H.A. Krause, p. 59.
2. Margaret Oppermann, p. 33.
3. T.W. Hardcastle, *Fassifern Guardian* 31 December 1958 quoted in Angela Collyer. pp. 51-2; Margaret Oppermann, p. 62.

Burnett's Creek Sawmill

View of fibro clad cottage on east side of sawmill site

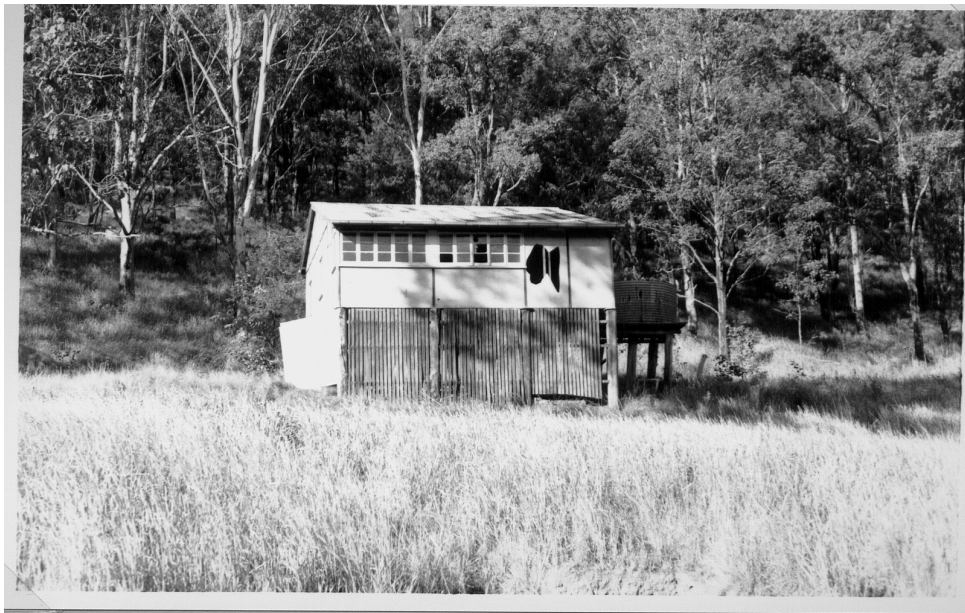

View of part of sawmill site showing rails set in concrete, concrete foundations obscured by vegetation



Close-up view of some of the concrete foundations for machinery possibly boiler and engine



204

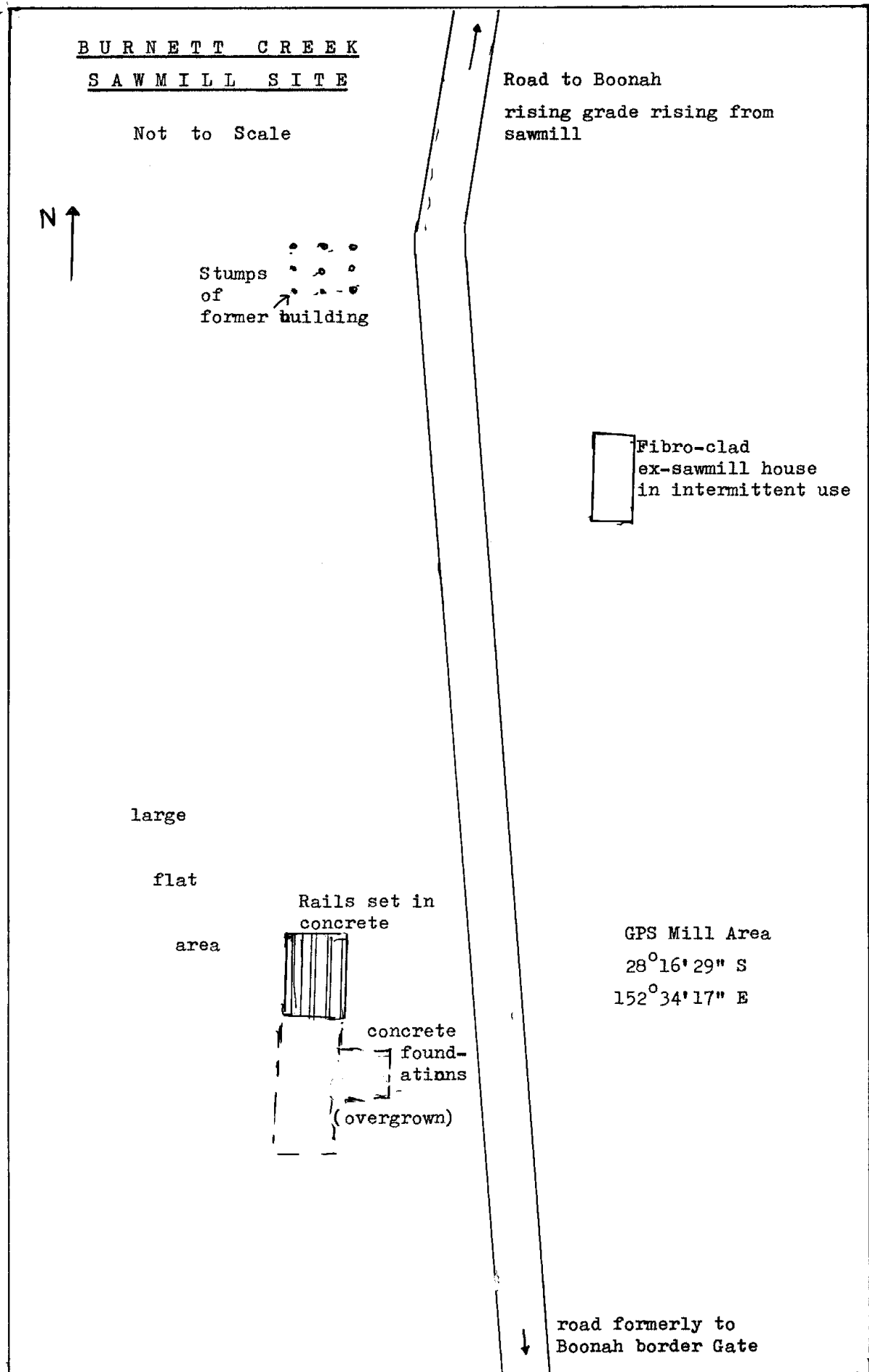

205

